

AKUN®



AKUN® AP200W Smart Pico Projector Manual

A/S Email : master@aikun.co

Please read this product manual carefully before using this product

Thank you for purchasing and using the products of Aikun (China) Electronics Company Limited (hereinafter referred to as "Aikun"). For your safety and benefit, please read this product manual carefully before using the product. If you fail to follow the product manual or precautions, Aikun will not be liable for any personal injury, property loss or other damage.

The copyright of this product manual (hereinafter referred to as "the manual")

belongs to Aikun ;

The trademarks and sizes mentioned in the manual belong to their respective rights owners;

If the content of the manual is inconsistent with the actual product, the actual product shall prevail.

If you have any objections to the contents or terms of the manual, please file a written objection to Aikun within seven days after purchase, otherwise you will agree, understand and accept the entire content of the manual.

Aikun reserves the right to interpret and modify the manual

Appearance

- 1 . Up
- 2 . Down
- 3 . Left
- 4 . Right
- 5 . OK
- 6 . Focusing-
- 7 . Focusing+
- 8 . Power button
- 9 . Back
- 10 . TF Card
- 11 . Projector light machine
- 12 . Projector light machine protective cover

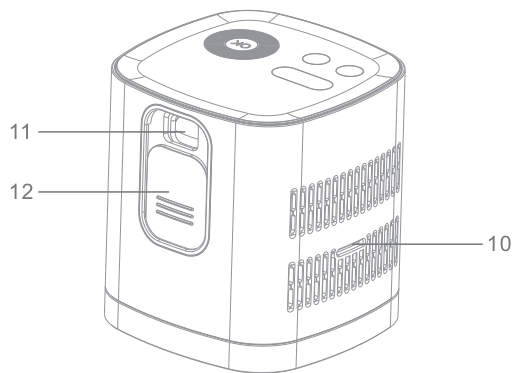
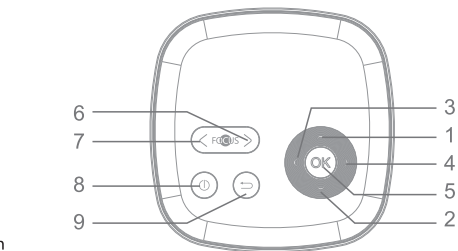

13. Indicator observation hole
14. HDMI IN
15. Reset
16. USB 1
17. Infrared receiver
18. Power Hole
- 19 . USB 2
- 20 . Adjustable base

Indicator description :

1. The light is out when the machine is turned on
2. The light is green when in charging state and is out when the battery is fully charged.
3. The light is red when battery is low

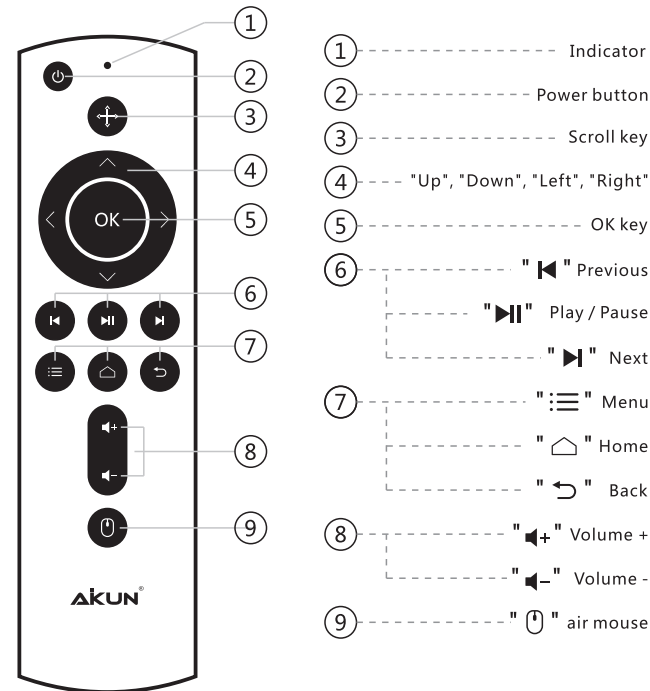
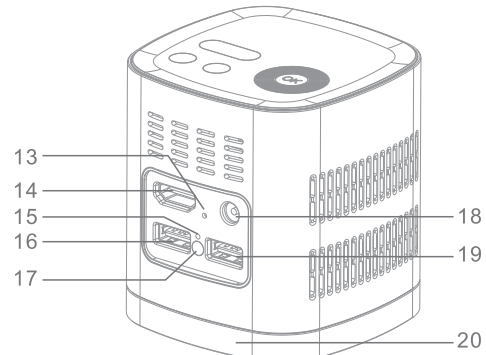

Operation Guide

Start up

1. Make sure that the machine has sufficient power. Press and hold the power button on the top of the machine for 2 seconds to turn on the machine.
2. Press and hold the power button on the top of the machine for 2 seconds while the machine is on, the shutdown window will pop up and the machine will shut down.
3. Short press the power button of the remote control / machine, the machine will enter standby state.

Focusing

When the machine is turned on and the main control interface is displayed, if the picture is not clear, you can press the focusing + / focusing- on the top of the machine body to adjust the picture until the picture is clear.

Icon description

Boot into the home page as shown below

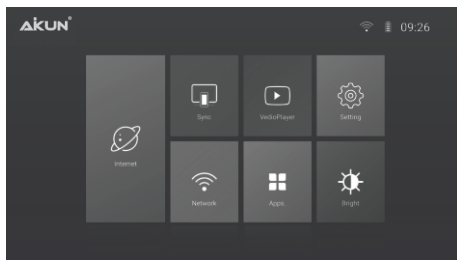

- 1 . **Web browser** You can browse the network when connected to the Internet.

2 . Display in same time connection

Click to enter the display in same time screen connection interface: including Android wireless display in same time, Apple wireless display in same time, Apple wired display in same time. Select the display in same time mode for the display in same time connection according to the mobile phone operating system.



Connect with Android wireless display in same time
Connect the projector and the mobile phone to the same WIFI.
The projector select the Android icon on the page to enter display in same time. Open the mobile phone "Settings" and find "Display" . Select the projection screen and the mobile phone automatically searches for the device. When the mobile phone finds the device with the projection name AIKUN_AP200W, click "Connect" and the "display in same time" is set.

Note: The name of Android Miracast may not be consistent, and may be multi-screen, multi-screen interaction or wireless sharing, wireless display, projection screen, depending on the mobile phone. There are compatibility issues because the instrument version is different.

Connect with Apple wireless display in same time
Make sure the iPhone / iPad and the projector are connected to the same WIFI
Slide out AirPlay mirroring / screen mirroring from the bottom of the main interface of the iPhone / iPad, click on the projector device name in the device list: AIKUN_AP200W to connect with the projector.

Connect with Apple wired display in same time
Use iPhone / iPad data cable USB to connect AIKUN_AP200W and Apple device, wait for about 20 seconds after the connection is successful and the display in same time will be successful.

Note: if the machine restarts after stand-by, it should turn on the APP in the same screen to connect again.

- 3 . **Video player** Click to enter the page of video playback.

- 4 . **Setting** Click to enter the setting page.

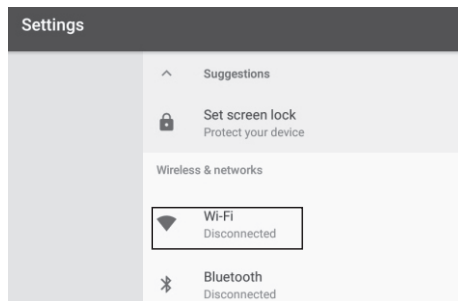

WiFi connection settings

Click WiFi settings, select your WiFi signal, and confirm to pop up the password input interface.

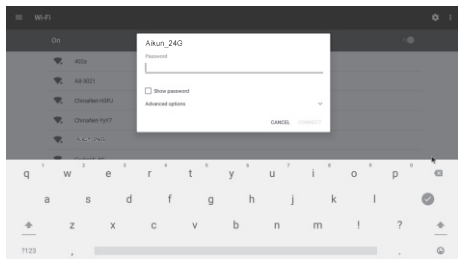

Enter your WiFi password and press the "Back" key, then select "Connect" to connect successfully.

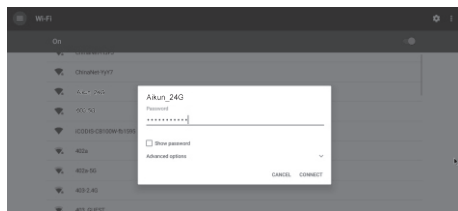

Bluetooth function introduction

Turn on the Bluetooth setting switch; search for the Bluetooth that needs to be paired, enter the password to pair and connect to Bluetooth.
Note: It supports various Bluetooth audio devices.

- 5 . **Quick setting for WiFi connection** Enter the page and select the WiFi signal to be connected.

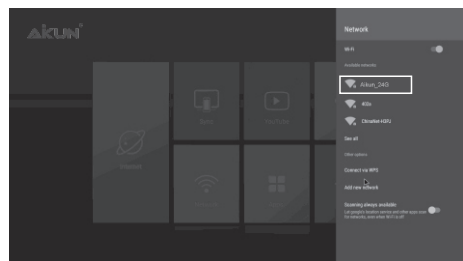

Click "Connect" to show the keyboard. After entering the password, click " > " to connect to the network.

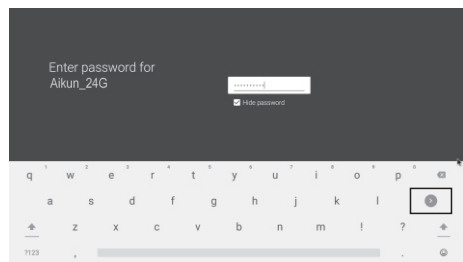

Select the connected network signal and press "OK" to view the IP parameters of the network.

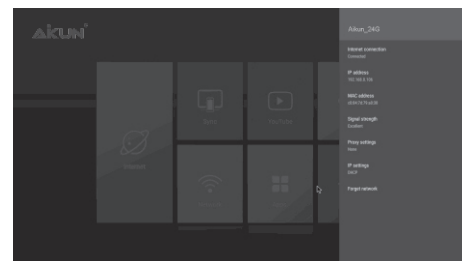

- 6 . **Menu** Click to enter the page, this page contains all the installation programs of the machine.



7 . Brightness

Click to enter the brightness adjustment interface and press the left and right arrow keys to adjust the light machine brightness.

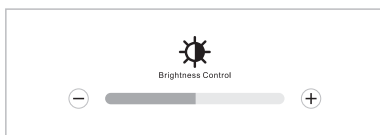

When this machine chooses to use HDMI, just plug in the HDMI cable to the device to be connected. It can be used for set-top boxes, personal computers, TV game instruments, etc.

CAUTION: Before running Restore Factory Settings and OTA Upgrade connect a 5V powersupply using a USB cable. Then connect the USB cable to the instrument.

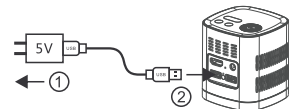

Warnings

- 1 . The strong light of this machine should not be directed into the eyes
- 2 . It is recommended to use this machine in an environment with relatively air circulation
- 3 . All holes of the machine should not be covered during use, to avoid machine failure due to poor heat dissipation
- 4 . Avoid using this machine in humid environment
- 5 . This machine contains precision optical components, so it should be avoided from severe collision
- 6 . It is recommended not to move the machine while it is working
- 7 . Children should use this machine under adult supervision
- 8 . This machine should not be disassembled without authorization, otherwise it will void your normal warranty service